



13000MAH WATER RESISTANT PORTABLE JUMP STARTER WITH WIRELESS CHARGER

CTJMPST13WA

SAFETY & WARNINGS

- Use only the included battery clamp to start the car.
- Do not use this unit if any part of the cable, clamp or cord is damaged.
- Never connect both clamps together when the product is turned ON.
- Do not connect both cable clamps to the same piece of metal. Otherwise, the jump starter will be damaged.

OVERVIEW

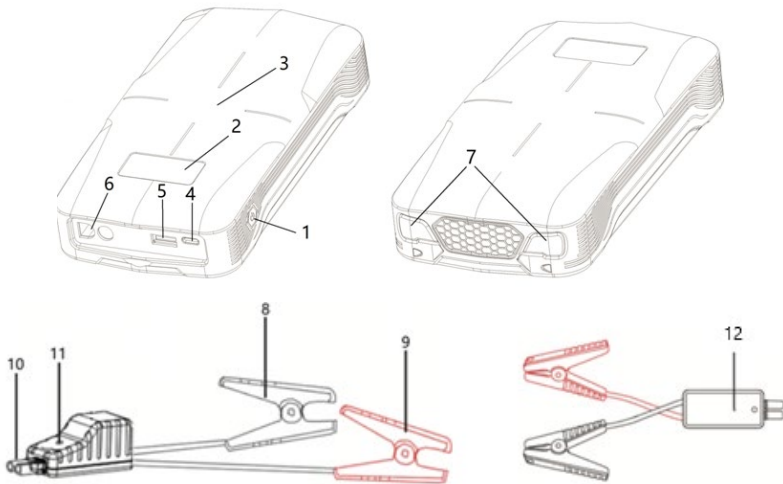

1	On/Off button (multifunctional)	Press the button to charge your devices. Press the button to see the remaining capacity. Long press the button to turn the flashlight on or off.
2	LED display screen	Displays: <ul style="list-style-type: none"> ○ Remaining power percentage. ○ Charge and discharge status. ○ Wireless charging status. ○ SOS status.
3	Wireless charging pad	Only functions with devices equipped with the wireless charging feature.
4	USB-C input port	Charge the product (via USB-A to USB-C cable).
5	USB output port (QC 3.0)	Charge external devices. QC 3.0 compatibility will be enabled for devices that support this function.
6	Jump-starting port	Insert the plug into the jump-starting port.
7	LED flashlight	Flashlight modes: Solid, SOS, Alert and Off
8	Black clamp	Connect the black clamp to the negative terminal of the car battery.
9	Red clamp	Connect the red clamp to the positive terminal of the car battery.
10	Plug	To be inserted into the jump-starting port for use (6)
11	Battery clamp indicator lights	Shows the status of the smart battery clamp.
12	Force start button	For instances where the car battery voltage is too low.

OPERATION

Charging the jump starter

1. Connect the product to a suitable wall adapter via the USB-C cable.
2. Short press the On/Off button to turn on the product. While charging the jump starter, the LED display screen will show the current battery power percentage. Once it is fully charged, the LED display screen will show 100%.
3. Unplug the cable when no charge is required.

Note:

- When using it for the first time, make sure that the jump starter is fully charged.
- Please use the provided USB-C cable to charge the product.
- A USB wall adapter is not included with the product.

Charging USB devices

1. Connect the product and the device to be charged via USB cable.
2. Press the On/Off button to turn on the product.
3. Unplug the cable when no charge is required.

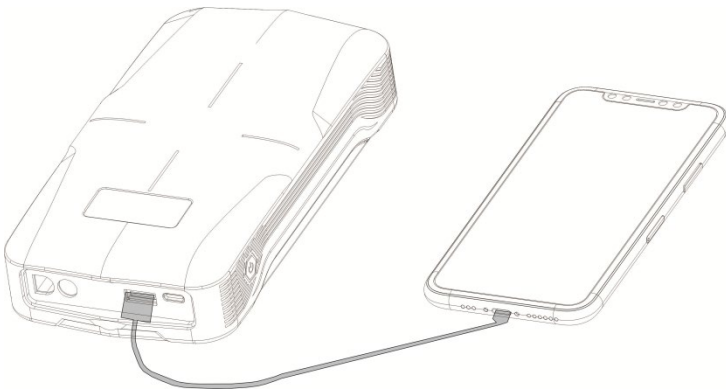

Wirelessly charging devices

1. Press the power button once to enable the wireless charging function.
2. Place the device on top of the wireless charging icon to start.
3. You may need to adjust the orientation of the device on the wireless charging pad for optimal results.

Note:

The wireless charging feature only works on devices that allow Qi (inductive) wireless charging. Only use the wireless charging pad with Qi-certified devices.

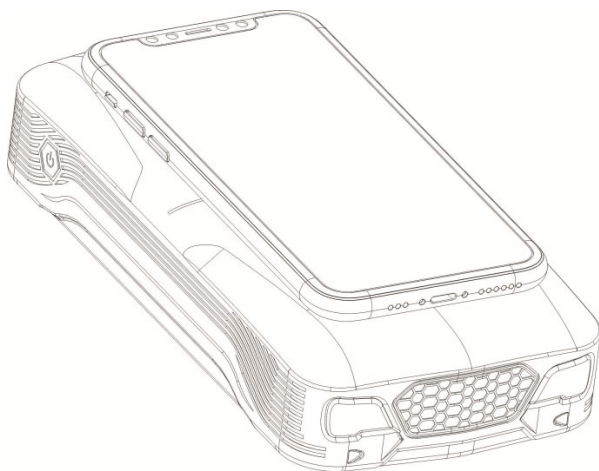

LED flashlight

Long press the On/Off button for 3 seconds to turn on the light. Short press the On/Off button to switch the light modes between Solid, SOS, Alert and Off.

Jump start your car

Note:

This product is for 12V cars only (up to 7.0L petrol or 5.0L diesel engine). Always ensure that the battery level is above 50% before you use it to jump start your car.

Step 1: Insert the plug of the smart battery clamp completely into the jump starter. If the green and red indicators on the battery clamp are flashing alternately, you are safe to move on to the next step.

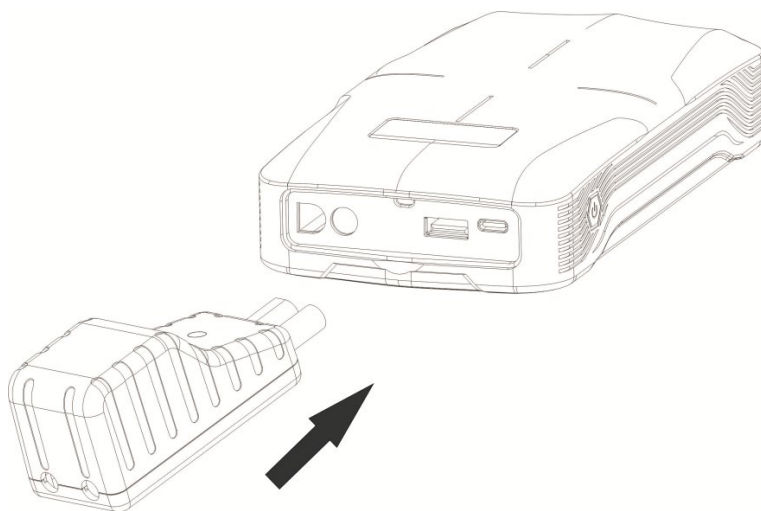

Step 2: Connect the red clamp to the positive terminal (+) of the car battery and connect the black clamp to the negative terminal (-) of the car battery. If the green and red indicators on the battery clamp are flashing alternately, you are safe to move on to the next step.

However, if the red indicator light is on:

- The battery clamp may be connected in reverse. If so, you need to disconnect the battery clamp from the vehicle and the jump starter.
- Adjust the clamps for maximum contact with battery terminals.

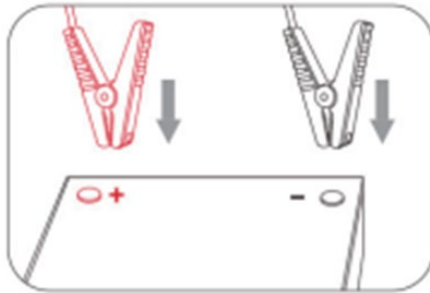

Step 3a: Start the car as normal.

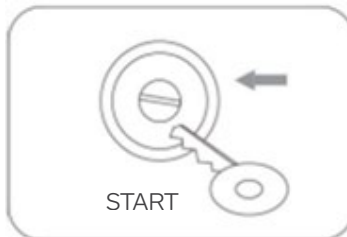

- If the car fails to start, disconnect the battery clamp from the vehicle and the jump starter. Wait for at least 30 seconds before trying again.
- If the car still fails to start after 3 attempts, use the force start function as per step 3b.

Step 3b (optional): Force start function.

- Make sure that the clamps are connected to the correct polarity battery terminal.
- Hold the force start button for 3 seconds to enable the force start function.
- When the indicator light of the smart clamp is solid green, the vehicle will need to be started within 30s.

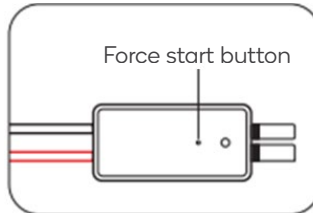

Step 4: Once your car is started, remove the battery clamp from the car battery and the jump starter within 30 seconds.

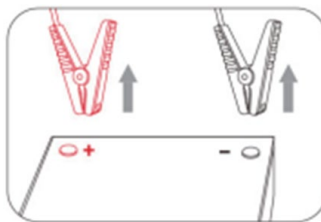

LED Indicator	Situation
Flashing between red/green	Ready to work/operational status
Solid red	<ol style="list-style-type: none">1. Battery clamp is connected in reverse:<ul style="list-style-type: none">○ Check the orientation of the clamps on the battery terminals2. The clamp is short-circuited:<ul style="list-style-type: none">○ Check whether the clamps are contacting one another or are connected to the same piece of metal.3. Reverse charging protection; the voltage of the car battery is higher than 12.6V:<ul style="list-style-type: none">○ No jump starting is needed to start the car.
Rapidly flashing red	The temperature of the clamp exceeds 65 (+/-5) degrees. Remove the clamp until the lights flash red and green.
Slowly flashing green	The voltage of the jump starter is too low. Charge the jump starter

CARE & MAINTENANCE

- Never use the product to start a bulging or damaged car battery.
- Store the product in a shaded, well-ventilated area.
- Handle the product with care. Avoid dropping or striking the product heavily and repeatedly.
- Do not attempt to disassemble or modify the product.
- Do not use detergents to clean the product.
- Do not place or use the product in a high-temperature environment for an extended period. The operating temperature of this product is -20-60° C. The storage temperature of the product should not exceed 50°C.
- Check the battery level of the product at least once every three months and charge the product in time.
- Keep the product away from children and pets.

SPECIFICATIONS

Capacity	13000mAh
Type C input	5V/2A
USB output	5V/3A, 9V/2A, 12V/1.5A
Wireless charging	5V/2A, 10W max
Jump-start current	500A (last for 1s)
Peak jump-start current	1000A (last for 0.2s)
Over-discharge protection	$\leq 13v \pm 0.3v$
Overheating protection	$> 65^{\circ}C \pm 5^{\circ}C$
Reverse charging protection	$\geq (2.6v \pm 0.3v)$
Dimensions (L x W x H)	180 x 92 x 36mm

FAQ

How is the product turned off?

This product will power off automatically when no load is detected or when charging is complete.

How long does it take to fully charge the jump starter?

Approximately 7 hours through the Micro USB or Type C input ports.

How many times can this product start the vehicle with full capacity?

Approximately 15 times.

How many times can this product fully charge my mobile phone?

This will depend largely on the battery capacity of the mobile phone being used. For example, an iPhone 8 can be fully charged ~3-4 times.

IN THE BOX

- 1 x 13000mAh Jump Starter
- 1 x Smart Battery Clamp
- 1 x USB Type C cable
- 1 x Quick Start Guide
- 1 x Carry Pouch

Need more information?

We hope that this user guide has given you the assistance needed for a simple set-up. For the most up-to-date guide for your product, as well as any additional assistance you may require, head online to **help.kogan.com**

kogan