



MUSCLE THERAPY BRUSHLESS MASSAGE GUN

KAMTMSGGUNA

SAFETY & WARNINGS

- This product is intended only for use by adults. It is not intended to be used by persons who have physical, sensory or mental deficiencies or lack of experience and knowledge of use, unless there is a person responsible for their safety who supervises or directs them in connection with the use of the appliance.
- The appliance should not be used directly on the skin. Suitable clothes or covering are suggested before use. Massaging is accomplished by regular movement; avoid lingering on the same point more than 1 minute.
- Do not apply high-speed or high-pressure on the head or bone extrusions (collarbone, spine etc). Only use the high-speed and high-pressure settings for soft tissues such as muscles to ensure no discomfort occurs.
- Frequent high-speed and high-pressure massaging in the same spot may cause abrasions. Discontinue use immediately when any discomfort occurs.
- Ensure that no extremities occupy the gap between the body of the unit and the massaging head during use, as this may lead to injury Do not insert any objects into the ventilation holes.
- Use the original adapter and battery for safety. Do not use unauthorised parts to replace the attachments.
- Ensure that the ventilation holes on the appliance are unobstructed.
- Never immerse the device in liquid or allow liquids to enter the ventilation holes.
- Check over the device to ensure its condition before use.
- Never leave the appliance unattended when it is operating or charging.
- Keep the appliance away from sources of liquid or heat.
- The maximum continuous working time is 1 hour. It is recommended to allow 30mins between each use of the product.
- Do not use the appliance while charging. Disconnect the battery from the adapter after each charge.
- Please consult your physician before use if your health is impaired, such as inflammatory/allergic reactions, pregnancy or lactation etc.
- Any consequences caused by not referring to the manual before use are.

IN THE BOX

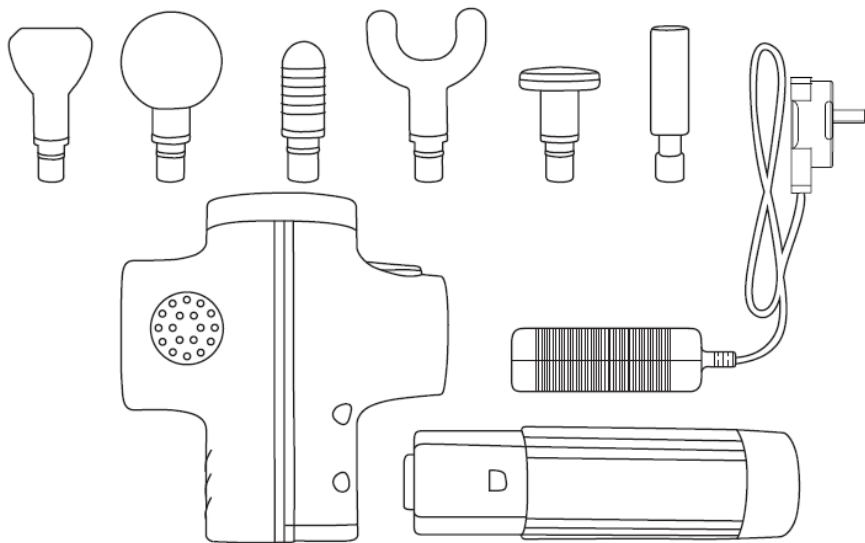

Main body	Battery
6x massaging heads	Power adaptor

OVERVIEW

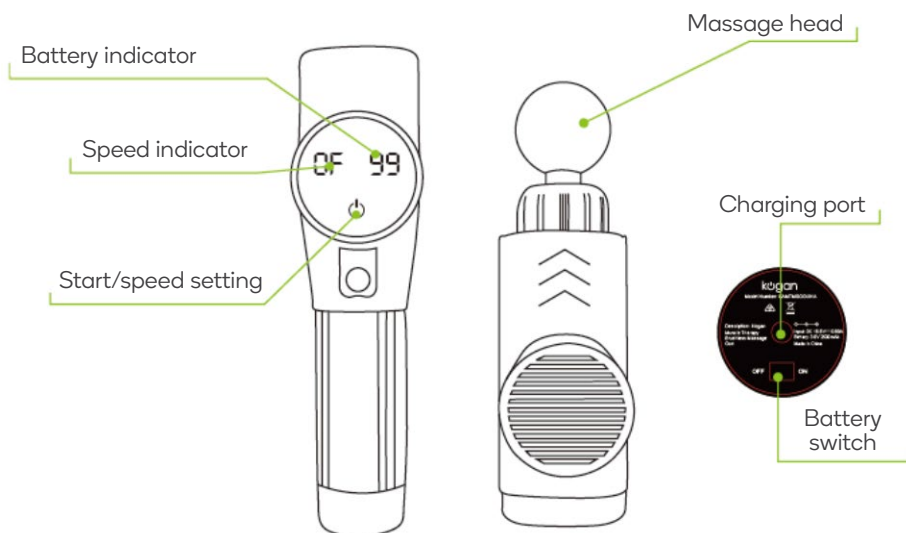
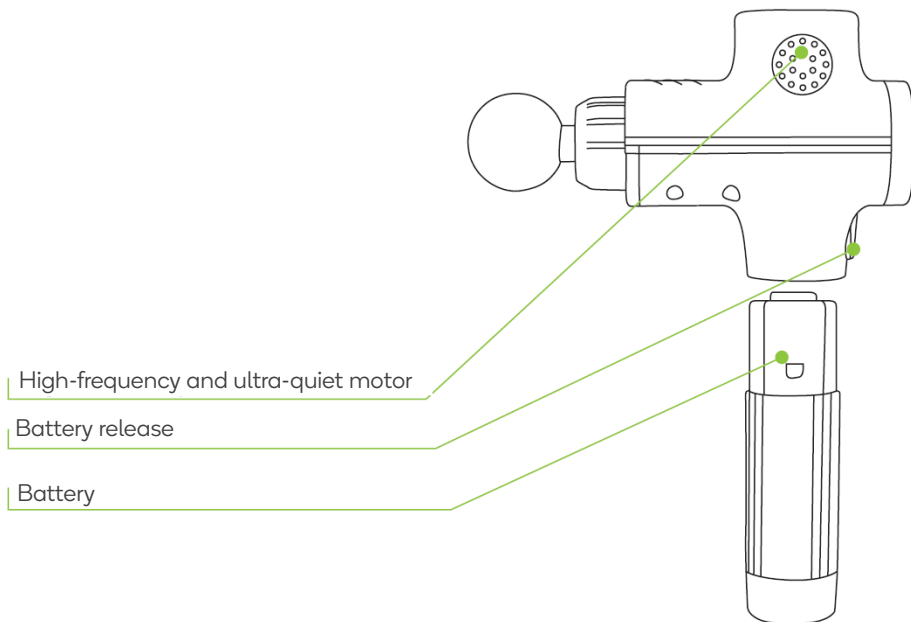

ATTACHMENTS



Shovel head

For the neck, shoulder and the lower back



Ball head

For large muscles



Spiral head

For joints



U-shaped head

For both sides of the spine



Flat head

For general body use



Cylinder head

For general body use with more penetration

OPERATION

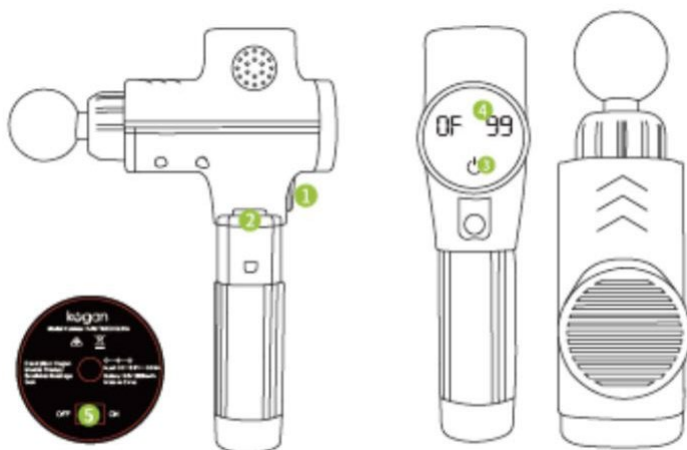

Tip: Ensure the appliance has been charged for at least 4 hours before first use. Follow the instructions on the following page for charging.

1. Insert the battery (2) into the body of the appliance by matching its protruding part with the battery release button (1).
2. Switch the battery on via the switch at the base (5). If the battery is fully charged, the panel will display 99. If it shows 20 or nothing, the battery needs to be charged.

Note: If experiencing difficulties, ensure the switch (5) is turned on and that the device is sufficiently charged.

3. Press and hold the start button for 3 seconds to turn it on/off. When it is turned off, it will display OF. When it is turned on, it will display 01-20.

Press and hold the start button to switch between the modes 01-20.

4. Choose the appropriate massaging head and speed according to the intended area of use.
5. Press the start button (3) to commence operation. The blue indicators will show the switchable speeds.
6. Turn the battery switch (5) off after use. Press the battery release button to remove the battery as required.

CHARGING

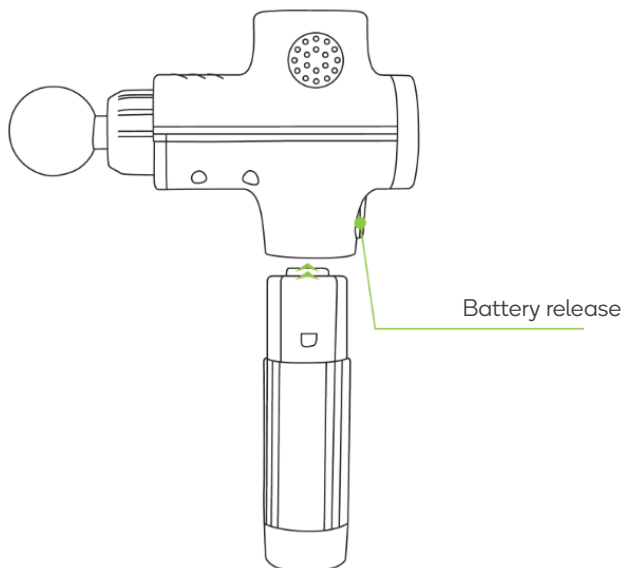

- Charge the appliance before use. Periodic charging and discharging will benefit the battery life.
- Connect the charging port of the battery with the DC end of the power adapter and plug the adapter into an AC socket to charge. The battery panel will display 99 to show that charging has finished.
- The correct way to insert battery is to match its protruding part with the battery removing button. Press the button to unload the battery.
- When the panel shows OF 99, this indicates the battery is full. When the panel shows OF 20 or is blank, this signifies charging is required. Try to charge the unit before the battery is fully depleted.

CLEANING & CARE

- Wipe the unit clean with a soft, dry cloth.
- If the product is not in use for an extended period or is taken for travel, please disconnect the battery and pack all the parts away carefully.

SPECIFICATIONS

Vibration frequency/speed	1. 20Hz/1800rpm 2. 30Hz/2000rpm 3. 40Hz/2200rpm 4. 50Hz/2400rpm 5. 60Hz/2600rpm
Battery type	3.6V, 2500mA
Weight	0.98kg (1.29kg packaged)
Charging power	110-240V 50/60Hz 5A 16.8DC 0.89A
Average operating time	~2 hours

Need more information?

We hope that this user guide has given you the assistance needed for a simple set-up. For the most up-to-date guide for your product, as well as any additional assistance you may require, head online to **help.kogan.com**

kogan.com