



KOGAN SMARTERHOME SWITCH

KAWFSWT1GA, KAWFSWT2GA & KAWFSWT3GA

SAFETY AND WARNINGS

WARNING: RISK OF ELECTRIC SHOCK OR FIRE.

Installing this product should only be completed by a qualified professional. Incorrect installation could cause injury or death.

Read all instructions and safety information. Review all diagrams provided carefully before installing your switch.

Ensure the following safety precautions are adhered to:

- This switch must be installed by a licensed and qualified electrician according to SAA and local authority regulations.
- This appliance is not intended for use by persons (including children) with reduced physical, sensory or mental capabilities, or lack of experience and knowledge, unless they have been given supervision or instruction concerning use of the appliance by a person responsible for their safety.
- Young children should be supervised to ensure that they do not play with the appliance.
- All electrical works must only be undertaken after disconnection of the power by removing fuses or turning off the circuit breaker, to ensure all pole isolation of the electrical supply.
- Do not use the product outdoors.
- This manual is not intended to instruct or assist untrained or unqualified persons to install this light switch.
- It is the responsibility of qualified, licensed installer and user to apply common sense and care at all times during installation and operation.

INSTALLATION

1. Open the switch cover carefully using a flat head screwdriver. Use a screwdriver that has a tip that is at least 5mm wide.

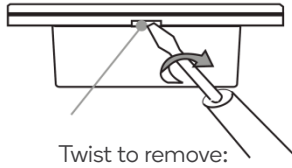

2. Use the following diagram to wire the switch correctly:

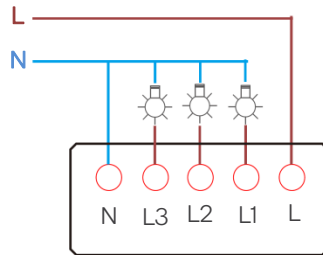

3. Tighten the screws.
4. Cover the panel and connect the power. After the power is on, please wait for 3 seconds and then press the switch.

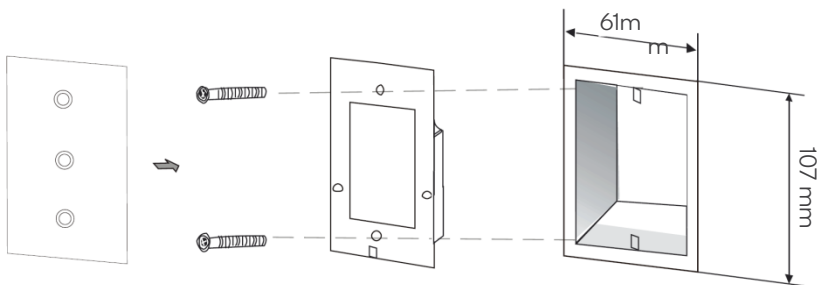

APP INSTALLATION

1. Download Kogan SmarterHome™ app from the App Store or Google Play. Register account.
2. Launch the app. Click “Register”.
3. Select your country code, enter mobile phone number and tap “Get” to get a message containing a verification code.
4. It will send you a verification code. Enter it in the “Verification Code” field, set your password and tap “Login”.

<

Register

Australia +61 >

E-mail address/Mobile number

Get Verification Code

I Agree [User Agreement](#) and [Privacy Policy](#)

<

Log In

Australia +61 >

E-mail address/Mobile number

Password

Log In

[Login with SMS](#) [Forgot Password](#)

I Agree [User Agreement](#) and [Privacy Policy](#)

Add Device

1. Tap +or Add “Device” button of the “Devices window”. The Add device screen appears (as shown in the picture). Select Smart Switch.
2. Make sure the green indicator flashes and then tap “next step”.
3. The “Add Successfully” message appears once connected.

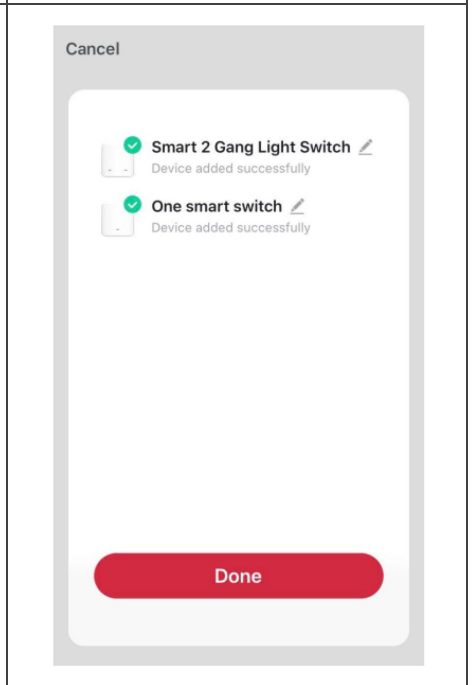
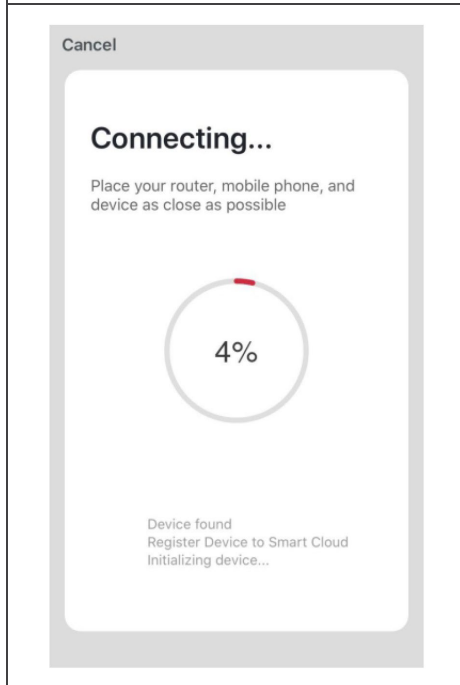
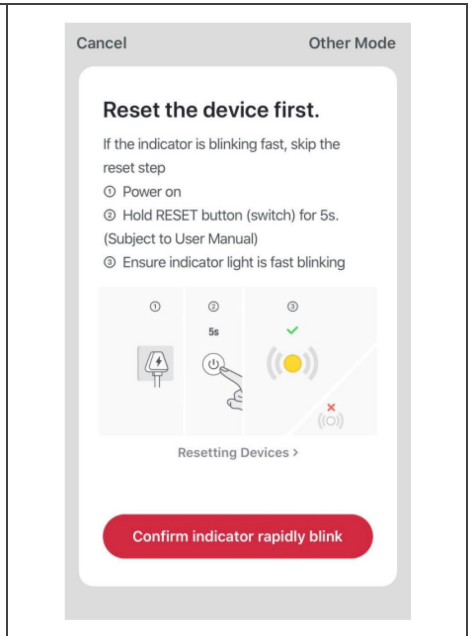
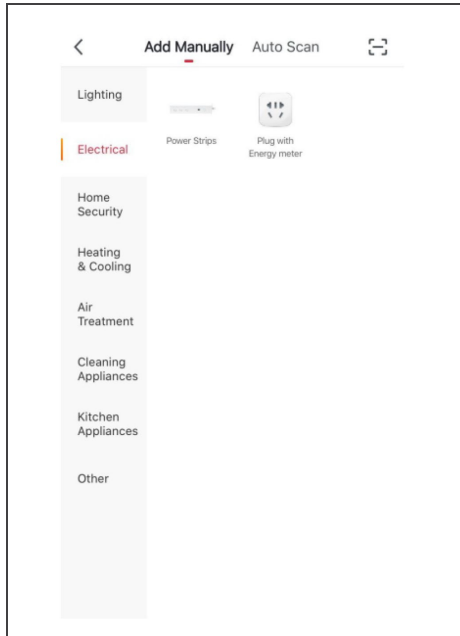

GOOGLE HOME CONTROL

Note: You will need to have set up a Google Home account prior to linking your Kogan SmarterHome™ device.

1. Select “Menu” and then “Home Control”.
2. In the “Home Control” screen, select the “+” icon in the bottom right.
3. A list will appear showing actions and a search function to access more apps from here, install the SmarterHome™ app.

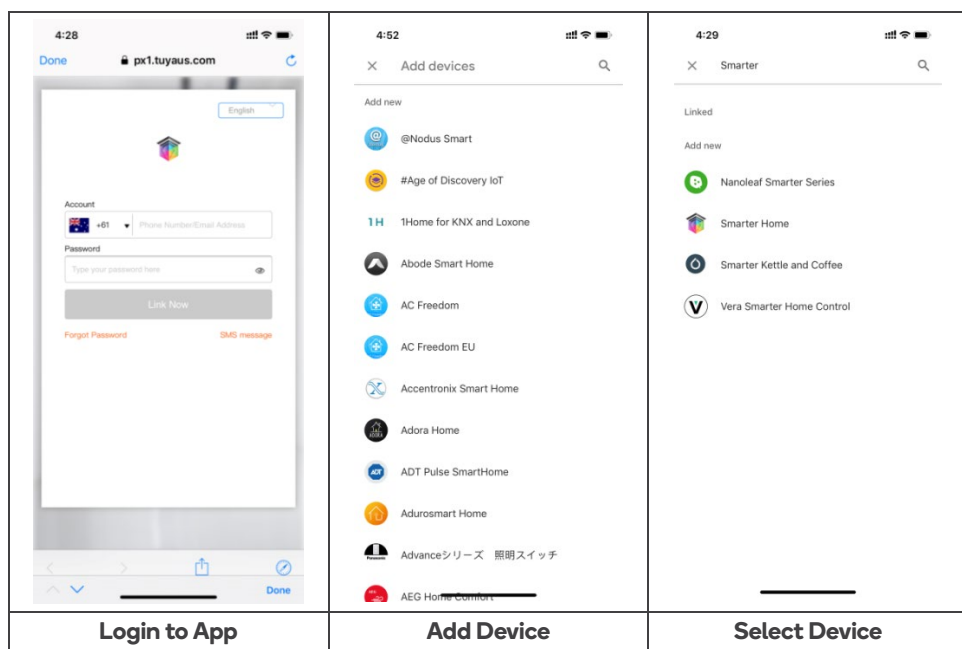

4. Log into your SmarterHome™ account with your email address or mobile number.
5. Once linked, it will show the devices linked to your account, you can assign them to rooms. You will be prompted to authorise apps to sync.
6. Click “Done” and then it will give you a list of commands available.
7. When successfully linked, you will see it on your “Home Control” screen at the bottom of the app screen. You can now control your Kogan SmarterHome™ devices through Google Home.

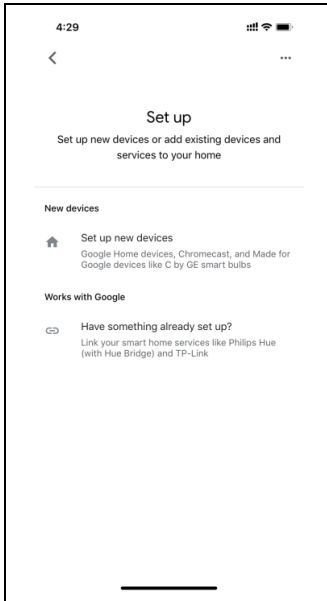

Set Up New Device

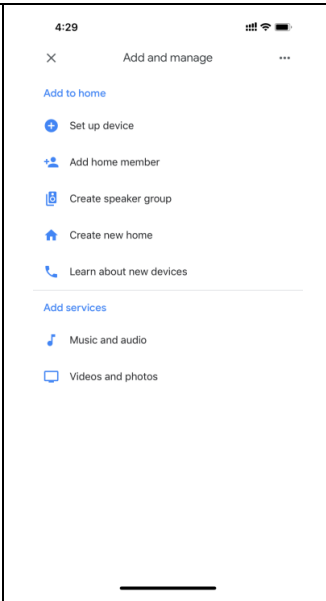

Add and Manage Device

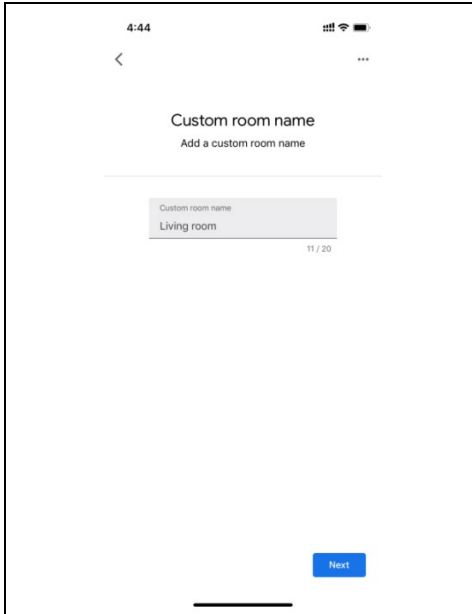
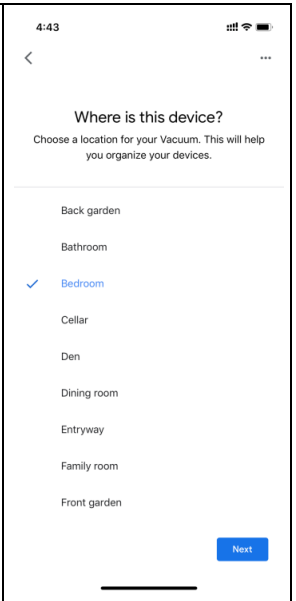

Assign Room

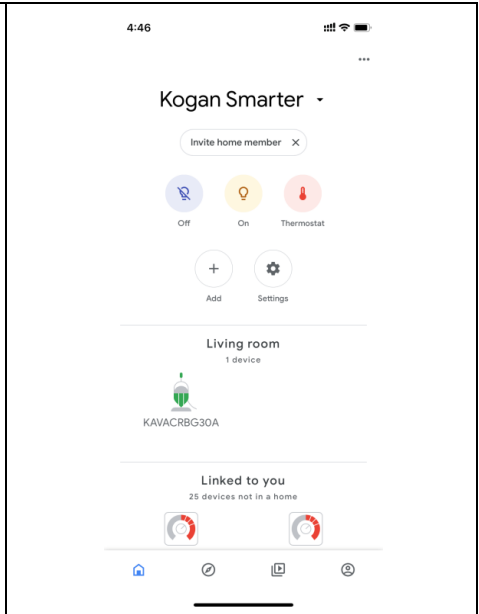

Update Home Control

ALEXA

Note: You will need to have set up an Alexa account prior to linking your Kogan SmarterHome™ device.

1. Select “Menu” and then “Skills”.
2. Search for the app and enable it.
3. Login to your SmarterHome™ account with your email address or mobile number.
4. Select “Discover Devices” and the app will begin searching.
5. When successfully linked, you will see a list of connected Kogan SmarterHome™ devices. You can now control your Kogan SmarterHome™ devices through Alexa with your voice.

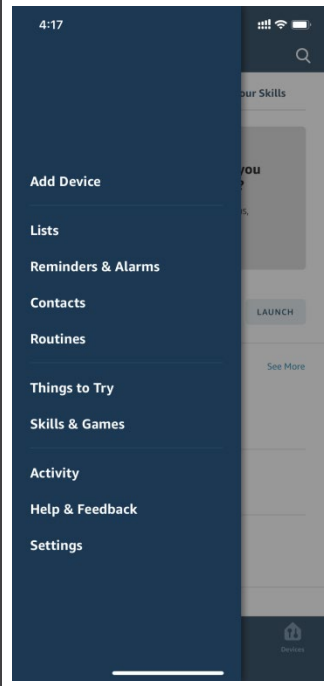
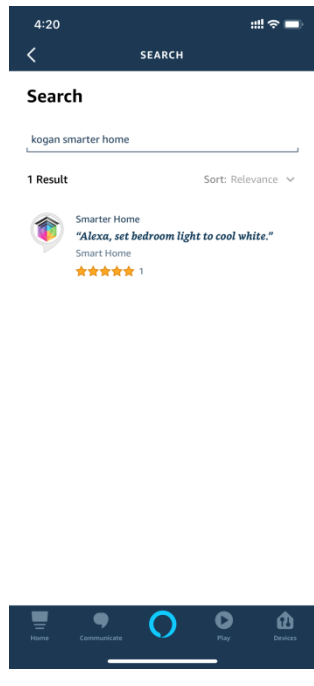
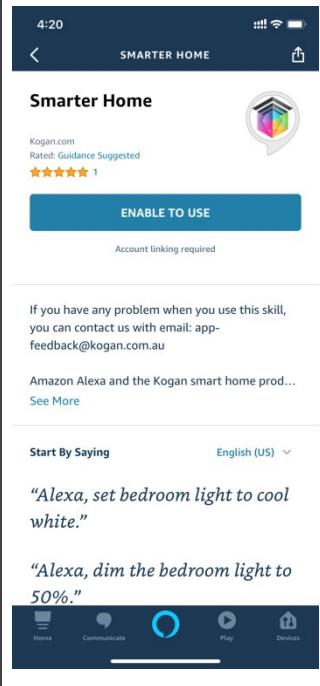
 <p>A screenshot of the Alexa mobile app interface at 4:17. The 'Skills' menu is open, showing options like 'Add Device', 'Lists', 'Reminders & Alarms', 'Contacts', 'Routines', 'Things to Try', 'Skills & Games', 'Activity', 'Help & Feedback', and 'Settings'. The 'Devices' icon is visible at the bottom right of the menu.</p>	 <p>A screenshot of the Alexa mobile app search results at 4:20. The search term 'kogan smarter home' is entered. One result is shown: 'Smarter Home' with a rating of 1 star and the skill description '“Alexa, set bedroom light to cool white.”'. The bottom navigation bar shows 'Home', 'Communicate', 'Play', and 'Devices'.</p>	 <p>A screenshot of the 'Smarter Home' skill enable screen at 4:20. It shows the skill name, a 1-star rating, and a blue 'ENABLE TO USE' button. Below the button, it says 'Account linking required'. There is also a section for 'Start By Saying' with sample voice commands: '“Alexa, set bedroom light to cool white.”' and '“Alexa, dim the bedroom light to 50%.”'. The bottom navigation bar shows 'Home', 'Communicate', 'Play', and 'Devices'.</p>
<p>Alexa Account Setup</p>	<p>Search App in All Skills</p>	<p>Enable App</p>

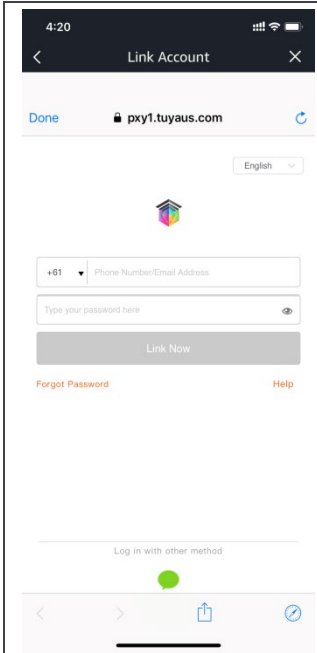

Login to App

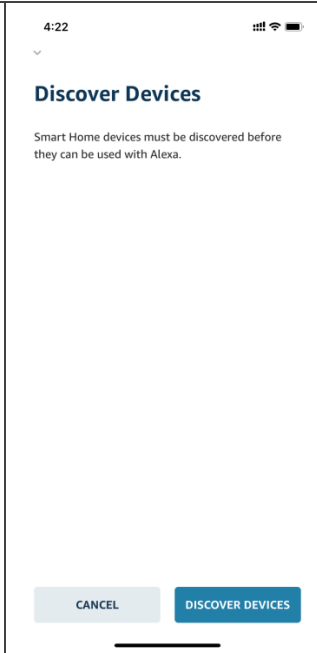

Discover Devices

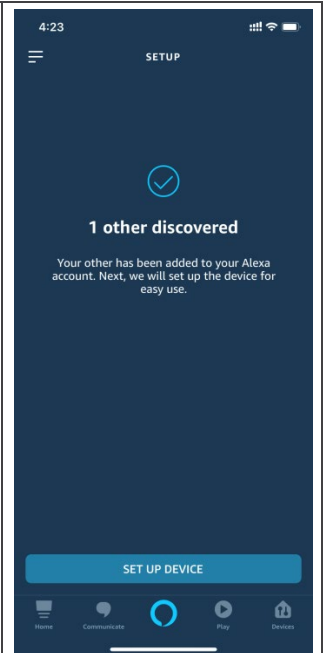

Setup Device

CONTROL PANEL

After selecting a Smart Switch from the 'Devices' screen, the Smart Switch Control Panel screen appears.

CONTROL PANEL: Switch ON

Tap the switch's image in the middle to switch the Smart Switch ON or OFF. When the Smart Switch is switched on, the switch's Control Panel options are displayed.

CONTROL PANEL: Switch OFF

Tap the switch image in the middle to switch the Smart Switch ON or OFF. When the Smart Switch is switched on, the switch's Control Panel options are displayed.

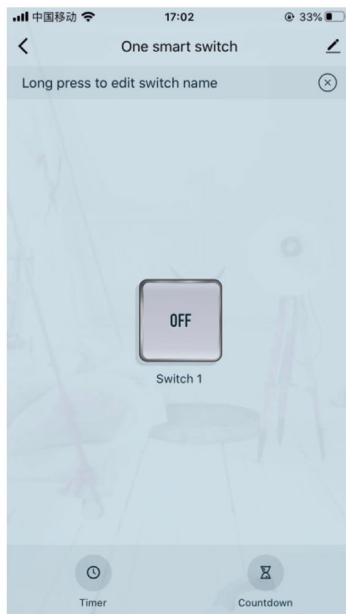

Resetting the switch for pairing

Reset: If the switch button is not flashing green, you need to press the button for 10-15 seconds until the green light starts flashing. Once it starts flashing it is ready for pairing.

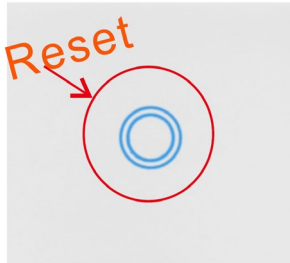

Figure 1

On/Off blue indicator

The blue light indicator can be toggled on or off. To do this open the glass cover and toggle the white switch on or off.

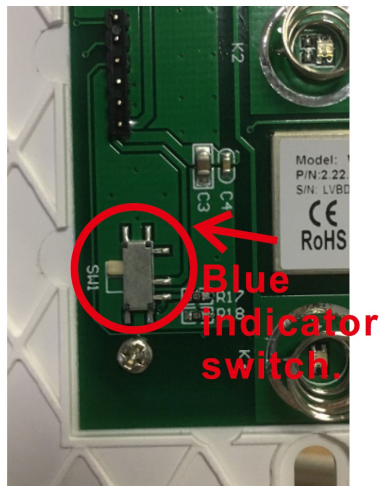
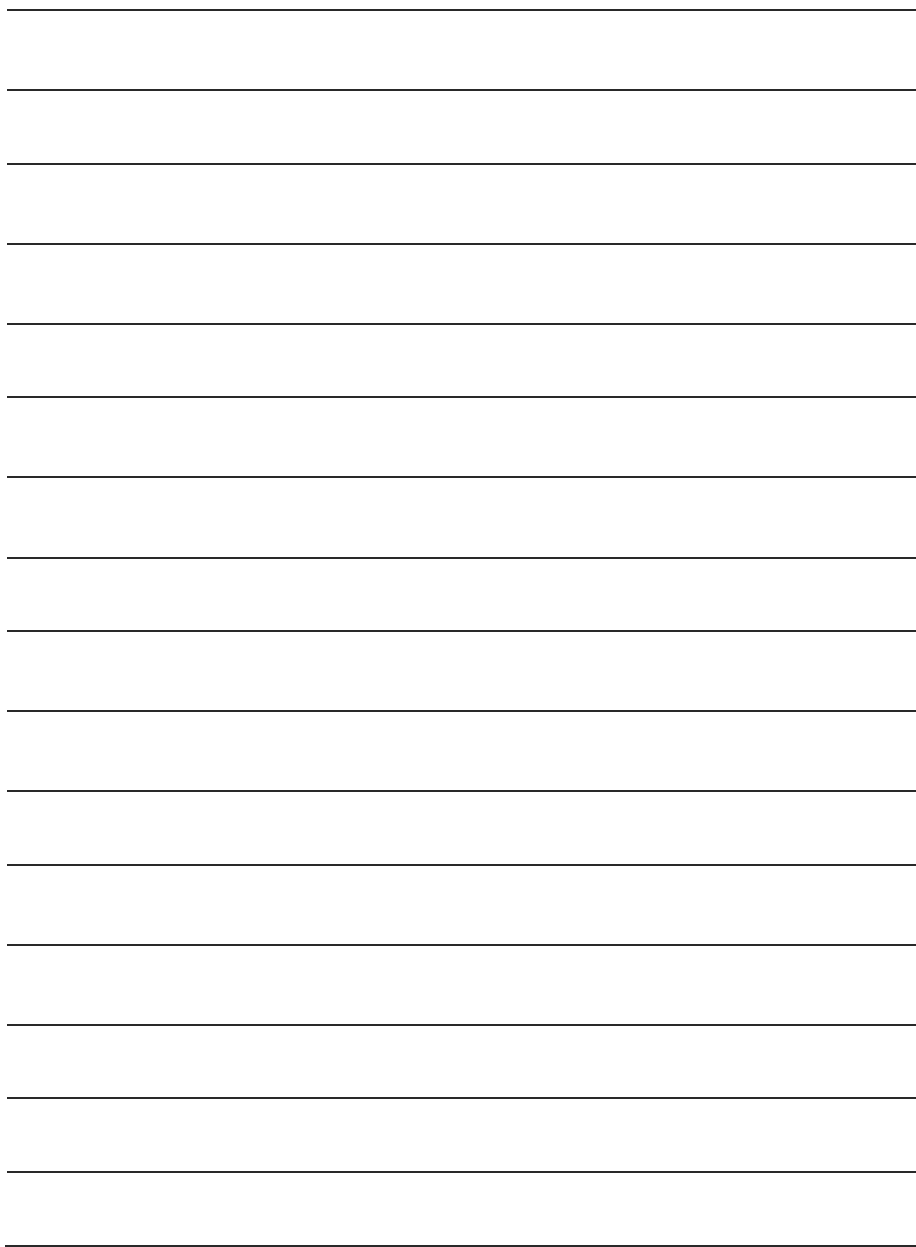

Figure 2

SPECIFICATIONS

Input Voltage	100-240V
Out Voltage	100-240V
Maximum Load	900W (300W/gang)
Working Frequency	2.4 GHz
Transmit Power	4dBm
Standby power consumption	< 1 W
Wireless Protocol	Wi-Fi 2.4GHz, IEEE 802.11b/g/n
ZigBee Repeater	Yes
Working Temperature	-20 °C - 45 °C
Working Humidity	< 80%



Need more information?

We hope that this user guide has given you the assistance needed for a simple set-up. For the most up-to-date guide for your product, as well as any additional assistance you may require, head online to **help.kogan.com**

kogan